

Heian Tension Shelf
Reinforced Mesh Top Tension Shelf - Deep

Medium RB-11E Large RB-12E

Instruction Manual

Thank you for purchasing this tension shelf.
This is a pressure-held type shelf that can be easily mounted and held in place without using nails or screws.
This product is mounted between walls or pillars and can be used as a storage shelf.
It is not to be used near water.

 **WARNING**

To ensure safe and proper use of the product, read these instructions before use. Failure to follow these precautions and instructions could result in serious injury and/or property damage.

Keep this manual nearby so that it can be referred to anytime during use of the product. Instructions are also available on our company website at <https://heianshindo.com/>.



- Necessary installable measurements for each model:

Medium

Width 29.6 - 47.3 in × Full depth Approx. 13.2 in × Height 3.6 in
* Depth of part of shelf : Approx. 12 in

Large

Width 46.5 - 74.8 in × Full depth Approx. 13.2 in × Height 3.6 in
* Depth of part of shelf : Approx. 12 in

Load capacity (reference values)	
RB-11E (Medium)	Installing with 29.6 in ...Up to 132.2 lbs Installing with 47.3 in ...Up to 88.1 lbs
RB-12E (Large)	Installing with 46.5 in ...Up to 110.2 lbs Installing with 74.8 in ...Up to 39.6 lbs

Material Indication	
Pipes Steel (Epoxy Resin Coating)
Resin parts ABS Resin, Polypropylene Resin, Synthetic Rubber
Screws Steel (Plating)

● The load capacity may decrease because of the magnitude of the pressure produced between the product and wall, installation length, wall material, and installation condition. As a result, the indicated load capacity is not a guaranteed value but is shown here for reference only.

● We will not compensate for failures, damage, and injuries due to things such as natural disasters, deterioration, alteration, inappropriate use, or failure to follow these instructions.

* We make every effort to manufacture products to ensure that they are free of defects. However, in case you find it defective, please contact the retailer where you purchased it.

* In order to improve quality, the specifications and/or appearance are subject to change without prior notice.

MADE IN CHINA
DESIGNED IN JAPAN
271222M



**HEIAN
SHINDO**

HEIAN SHINDO KOGYO CO., LTD.
<http://www.heianshindo.com>

Precautions to Prevent Injury or Damage

- Failure to obey these precautions may cause the tension shelf to fall off the walls, leading to serious injury and/or property damage.

- Do not use this product to protect an individual or their property such as for use as a handrail or guard or for any purpose other than the intended use described in these instructions. Doing so could result in the tension shelf falling, leading to injury and/or physical damage.

- Do not install this product above or near hazardous material such as chemicals, cutting tools or other items that could cause injury, combustion equipment, heating equipment, or above a place where people normally are located. Things on the shelf may catch fire or may fall and cause injury.

- Keep children away from the product while assembling or installing it. This is to avoid accidental ingestion of small parts, and injuries resulting from tripping on a component.

- Do not leave plastic packaging within reach by small children as it may lead to suffocation or other accidents.

- Do not modify shelf. Doing so could cause shelf or objects put on the shelf to fall and cause injury.

- When installing and using the product, observe the following:

- Install the product where the concrete walls, pillars and their walls and foundations are strong enough to withstand pressure produced by the shelf during the entire period of use. For weak walls such as those made of wall board or veneer, mount the product where there is a crosspiece or stud, or attach the shelf to a wall using a commercial wooden board.

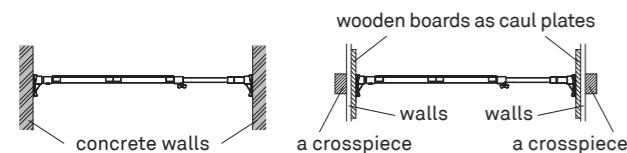

- The product should not be installed on a slope, curved or uneven surface.
- Do not use the product in areas subject to high temperatures, direct sunlight, high humidity or direct contact with water, or outdoors or in bathrooms.
- Install horizontally (perpendicular to the wall) and not vertically.
- Install the shelf with the fixing screw side facing down.
- Install the product within the necessary installable measurements indicated above.
- Do not install the product so that it exceeds the stop line (see illustration on next page).
- Tighten the fixing screws fully into the underside of the adjustment pipes.
- Be sure to set the end cap in the correct direction as indicated in installation procedure (6) below.
- Use the product within the indicated load capacity shown below.
- When putting things on the shelf, apply a load that is evenly distributed.
- Avoid applying shock loads to the shelf such as pulling it down strongly, shaking it, or hanging from it.
- Discontinue use immediately if any damage or abnormalities are found.
- Check the installation condition of the product a few days after installation, and then weekly.

- Be careful not to allow the fixing screw to hurt your hand as its end is sharp like a drill.

- Since the product presses strongly against the walls, marks may remain on the walls after the shelf is removed. Use the product where such marks will not lead to appearance problems.

- To not damage the walls, adjust the fitting pressure with the grips while checking on the conditions of the wall surfaces to which the shelf is mounted.

- Do not install the product above or near valuable or breakable objects, or above a faucet. If things on the shelf, or the shelf itself fall, property damage can occur.

- Keep the shelf clean so clothes or other objects do not get dirty. Wipe off any oil or dirt you see.

- Deodorants, air fresheners, cosmetics, hairdressing liquids, acid detergents, alkaline detergents, oils and organic solvents (benzene, thinner, etc.) can deteriorate the product. In case of contact, immediately clean the shelf and remove these substances.

- Wipe off any dirt with a neutral detergent diluted with water. After cleaning, remove the detergent completely and then wipe with a dry cloth. Do not use a scouring or polishing powder since it will damage the product.

- Scratches on the pipes' surface may cause them to dirt to penetrate or rust.

- Do not tighten the screws at an angle. It may cause damage.

Installation procedures

- 1) Check the condition of the wall on which the shelf will be mounted.
 - Follow above safety precautions during installation.

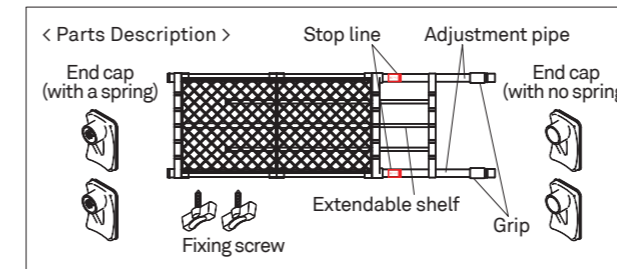

- 2) Rotate the grips in the direction of 【つばり】"stretch (press against wall)" to check that the grip operates properly. Then rotate the grips in the direction of 【ゆるむ】"retract (loosen)" until the grip end returns approximately to the start line. Excessive retraction may cause mechanical damage.

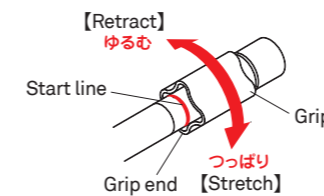

- 3) Attach the end caps to the shelf. Before attaching them, identify that there are two cap types, one with a spring and the other with no spring (2 each, 4 in total). Securely fit those with a spring to the fixed side, and those with no spring to the extendable side.

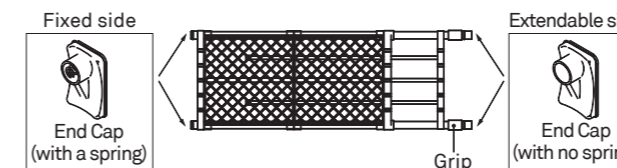

- 4) Tighten the shelf's two fixing screws shown in the illustration below with two to three turns to just temporarily tighten them.

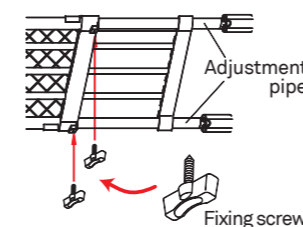

- Be careful not to allow the fixing screw to hurt your hand as its end is sharp like a drill.
- If the fixing screws has been tightened too much, the adjustment pipes cannot be pulled out, or can become scratched.
- Do not tighten the screws at an angle. It may cause damage.

- 5) Extend the adjustment pipes (until the end caps on both ends are fitted to the walls) so that the shelf length is equal to the distance between the walls.

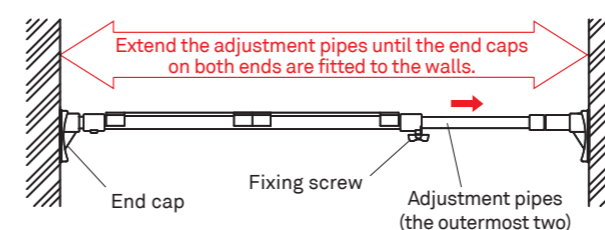

- Install the shelf with the fixing screw side facing down.
- Install horizontally (perpendicular to the wall).
- When extending the adjustment pipes to the limit, a stop line appears. Do not extend the adjustment pipes over this line.

- 6) To set the length of the shelf, tighten the fixing screws fully into the underside of the adjustment pipes. Doing so will result in the screws drilling a hole in the pipes.

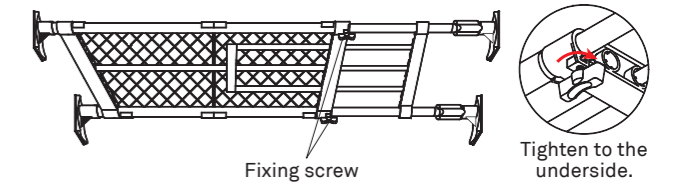

- Make sure that the end caps are oriented as shown below and that the bottom of the end cap plate is level and horizontal to the floor. Make sure that the end caps adhere to the wall. Incorrect mounting will cause the product not to function properly and to fall off the walls, leading to injury and/or property damage.

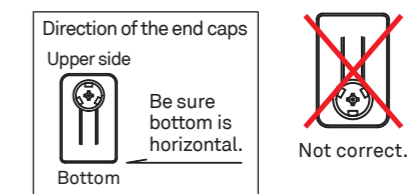

- 7) Rotate the grips in the direction of 【つばり】"stretch (press against wall)" shown in the label and this product will be tightly fixed by the tension force. To rotate the grip, hold the end cap with your hand so that it doesn't turn. In addition, turn the two grips uniformly so that uniform fitting pressure (mounting strength) is applied.

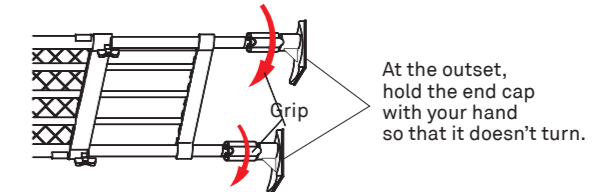

- To not damage the walls, adjust the fitting pressure with the grips while checking on the conditions of the wall surfaces to which the shelf is mounted.
- Install horizontally (perpendicular to the wall).
- If you continue rotating the grip, a "stop line" will appear. If the end of the grip exceeds this line, it may have been incorrectly installed, or it may not be available for the installation location. Recheck the necessary installable measurements and start over from step 1). Incorrect mounting will cause the product not to function properly and to possibly fall off the wall, leading to serious injury and/or property damage.

- 8) Before use, lightly try to move the shelf to be sure it is secured in place. Pull out the extendable shelf part according to the way it will be used.

